

RoHS

## TALEXchain P521-3 TALEXchain STANDARD

### Product description

- LED chain for highlighting lines and edges and for side injection
- Ready made chain comprising 5 P111-3 strips
- For safety lighting, general lighting, effect lighting and shelf lighting
- Suitable for TALEXaccessories PROFILE Z200-2 / 201-2 / Z22W-2
- Edge injection of transparent or diffuse materials
- Low profile
- Dimmable by pulse width modulation (PWM)
- Integrated current source to stabilise luminous flux
- Flexible chain, can be split between any module
- Beam characteristic: 140°
- Attached with M4 plastic screw or double-sided adhesive tape
- Connection: Cable 200 mm

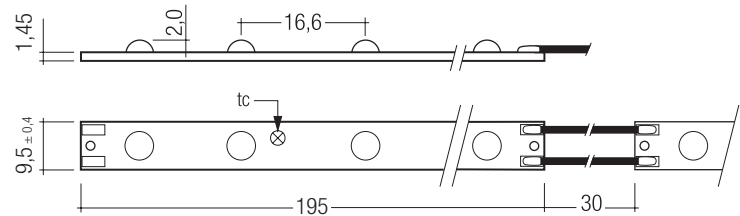

### Technical data

|                            |                |
|----------------------------|----------------|
| Ambient temperature $t_a$  | -25 ... +50 °C |
| tc point <sup>①</sup>      | 75 °C          |
| Risk group (EN 62471:2008) | 0              |



Standards, page 3

Colour temperatures and tolerances, page 4

### Ordering data

| Colour <sup>④</sup>               | Wavelength | Colour temperature | Type      | Article number |
|-----------------------------------|------------|--------------------|-----------|----------------|
| <b>12 light points per module</b> |            |                    |           |                |
| Daylight white                    | –          | 6,500 K            | P521-3 DL | 89601057       |
| Neutral white                     | –          | 4,200 K            | P521-3 NW | 89601056       |
| Warm white                        | –          | 3,000 K            | P521-3 WW | 89601055       |

Packaging: 2 pieces/package, 110 pieces/carton, 1,540 pieces/pallet

### Specific technical data

| Type                              | Number of modules | Typ. luminous flux per module <sup>②</sup> | Supply voltage DC <sup>③</sup> | Typ. current per module <sup>②</sup> | Typ. power per module | Luminous efficacy | Total length |
|-----------------------------------|-------------------|--------------------------------------------|--------------------------------|--------------------------------------|-----------------------|-------------------|--------------|
| <b>12 light points per module</b> |                   |                                            |                                |                                      |                       |                   |              |
| LED P521-3 DL 24V                 | 5                 | 106 lm                                     | 24 V                           | 74 mA                                | 1.8 W                 | 19 lm/W           | 1,495 mm     |
| LED P521-3 NW 24V                 | 5                 | 77 lm                                      | 24 V                           | 74 mA                                | 1.8 W                 | 22 lm/W           | 1,495 mm     |
| LED P521-3 WW 24V                 | 5                 | 68 lm                                      | 24 V                           | 74 mA                                | 1.8 W                 | 26 lm/W           | 1,495 mm     |

<sup>①</sup> If the max. temperature limits are exceeded, the life of the module will be greatly reduced or the module may be damaged. For the precise position of the tc point see the above diagram.

<sup>②</sup> Tolerance range for optical and electrical data: ±15 %.

<sup>③</sup> Exceeding the max. operating voltage leads to an overload on the TALEXchain. This may in turn result in a significant reduction in lifetime or even in destruction. Tolerance range for the supply voltage: 24 V: +2 V / -0 V.

All values for  $t_a = 25$  °C.

Converter matrix – TALEXchain P521-3

|                   |                | IN-BUILT LCU         |                 |                 |      |      |      | REMOTE LCU           |                 |                   |      |                 |      |      |      |    |  |               |
|-------------------|----------------|----------------------|-----------------|-----------------|------|------|------|----------------------|-----------------|-------------------|------|-----------------|------|------|------|----|--|---------------|
| Type              |                | LCU 060/24 D010      | LCU 100/24 D010 | LCU 150/24 D010 |      |      |      | LCU 035/24 E020      | LCU 060/24 E020 | LCU 100/24 E020   |      | LCU 150/24 E020 |      |      |      |    |  |               |
| Article number    |                | 24185184             | 24185185        | 24185186        |      |      |      | 24166320             | 24166324        | 24166328          |      | 24166333        |      |      |      |    |  |               |
|                   |                | Assignable converter |                 |                 |      |      |      | Assignable converter |                 |                   |      |                 |      |      |      |    |  |               |
| Type              | Article number | Number of modules    |                 |                 |      |      |      |                      |                 | Number of modules |      |                 |      |      |      |    |  | Max. chaining |
|                   |                | Min.                 | Max.            | Min.            | Max. | Min. | Max. | Min.                 | Max.            | Min.              | Max. | Min.            | Max. | Min. | Max. |    |  |               |
| LED P521-3 DL 24V | 89601057       | 4                    | 28              | 8               | 48   | 15   | 72   | 3                    | 16              | 4                 | 28   | 8               | 48   | 15   | 72   | 25 |  |               |
| LED P521-3 NW 24V | 89601056       | 4                    | 28              | 8               | 48   | 15   | 72   | 3                    | 16              | 4                 | 28   | 8               | 48   | 15   | 72   | 25 |  |               |
| LED P521-3 WW 24V | 89601055       | 4                    | 28              | 8               | 48   | 15   | 72   | 3                    | 16              | 4                 | 28   | 8               | 48   | 15   | 72   | 25 |  |               |

**Standards**

- EN 62031
- EN 62471

The product meets the "inbuilt LED module" classification according to EN 62031.

**Wiring**

Cable: AWG24; length 200 mm

|          |     |       |
|----------|-----|-------|
| Colour   | red | black |
| Function | +   | -     |

**TALEX chains in conjunction with water**

- Admissible Environmental Conditions:  
The LED modules are provided with a protective coating to guard against superficial dewing (according to JEDEC JESD22 A100C) and high relative air humidity. If the protective coating is damaged (for example during soldering) it must be rebuilt to sustain the same level of protection.
- Harmful Environmental Conditions:  
The product is not designed to be operated in contact with water.

| tc temperature in °C | Luminous flux in % | Life time in h |
|----------------------|--------------------|----------------|
| 45                   | 80                 | 22,000         |
|                      | 70                 | 35,000         |
|                      | 50                 | 65,000         |
| 75                   | 80                 | 19,000         |
|                      | 70                 | 30,000         |
|                      | 50                 | 55,000         |

**Light distribution**

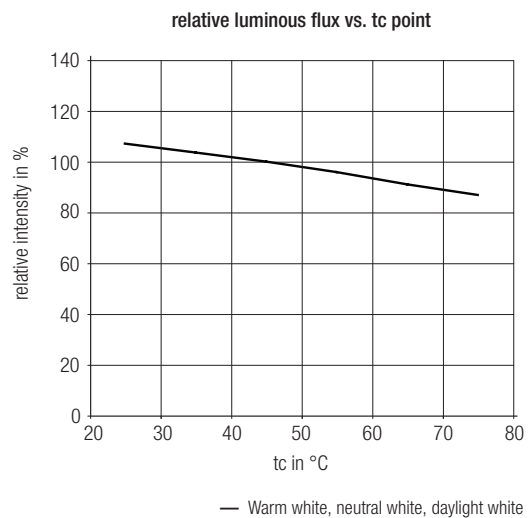
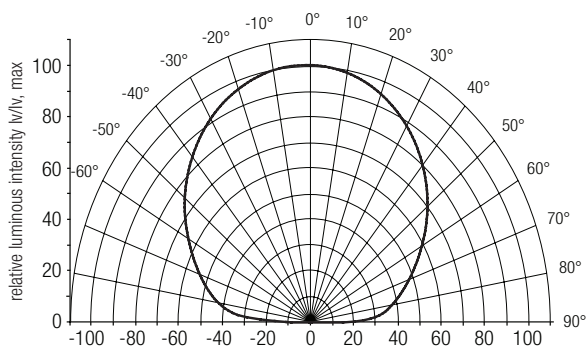

**Coordinates and tolerances according to CIE 1964**

The specified colour coordinates are measured by a voltage impulse of 24 V and a duration of 100 ms.  
The ambient temperature of the measurement is  $t_a = 25\text{ }^\circ\text{C}$ .

**CIE coordinates:**

**6,500 K**

|        | x0     | y0     |
|--------|--------|--------|
| Centre | 0.3200 | 0.3270 |

MacAdam ellipse: 5SDCM

**Daylight white**

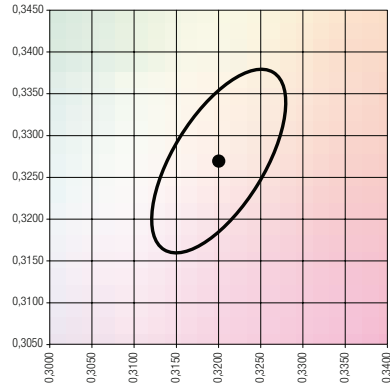

**CIE coordinates:**

**4,200 K**

|        | x0     | y0     |
|--------|--------|--------|
| Centre | 0.3770 | 0.3660 |

MacAdam ellipse: 5SDCM

**Neutral white**

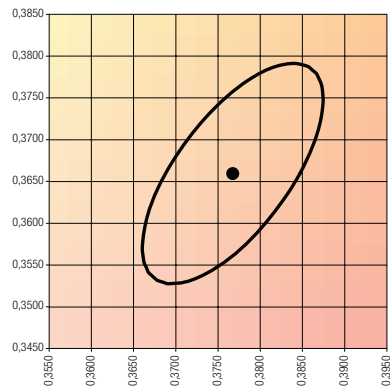

**CIE coordinates:**

**3,000 K**

|        | x0     | y0     |
|--------|--------|--------|
| Centre | 0.4460 | 0.3990 |

MacAdam ellipse: 5SDCM

**Warm white**

