

**Magnetic chokes**  
High pressure sodium lamps and metal halide lamps

**OFBIS/OFBS 250–400 W without thermal protection**



•  $t_w = 130\text{ }^\circ\text{C}$

Packaging:	Code	Box	Pallet
OFBIS 250 ... /50	1	4	288
OFBIS 250 ... /60	2	6	378
OFBS 400 ... /50	3	4	216
OFBS 400 ... /60	4	4	288

**Standards:**  
EN 61347/923

Figure 1

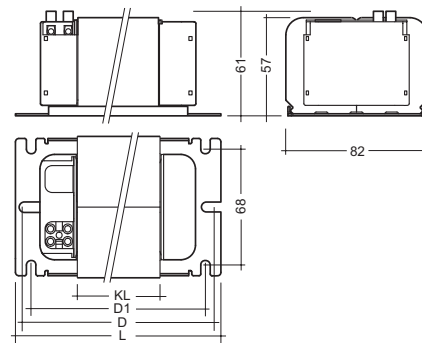

screw terminal 1–4 mm<sup>2</sup>

Figure 2

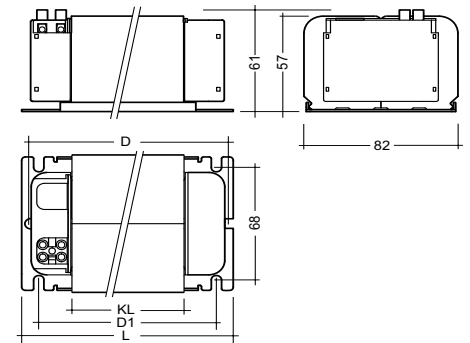

screw terminal 1–4 mm<sup>2</sup>

Lamp		Choke														P. F. Correction	
type	watt-age W	nominal lamp current A	type	article number	voltage V	pack-aging code	fig.	length L mm	KL mm	fixing centres mm		weight kg	$\Delta T$ K	losses W <sup>Ⓜ</sup>	$\lambda$	parallel	
																capacitor $\mu\text{F} \pm 10\%$ 250V	line current A <sup>Ⓢ</sup>
HI/HS	250	3.00	OFBIS 250 A000K 220/50	27002366	220/50	1	1	133	60	119.8	113.5	2.32	70	20.8	0.43	32.0	1.35
HI/HS	250	3.00	OFBIS 250 A001K 230/50	27002367	230/50	1	1	133	60	119.8	113.5	2.32	75	22.1	0.40	32.0	1.35
HI/HS	250	3.00	OFBIS 250 A002K 240/50	27002368	240/50	1	1	133	60	119.8	113.5	2.32	75	23.4	0.40	32.0	1.35
HI/HS	250	3.00	OFBIS 250 A005K 220/60	27002342	220/60	2	2	103	50	–	83.5	2.00	75	21.0	0.43	25.0	1.35
HI/HS	400	4.45	OFBS 400 A000K 220/50	27002377	220/50	3	1	163	90	149.8	143.5	3.36	70	29.0	0.45	45.0	2.10
HI/HS	400	4.45	OFBS 400 A001K 230/50	27002378	230/50	3	1	163	90	149.8	143.5	3.36	75	29.8	0.43	45.0	2.10
HI/HS	400	4.45	OFBS 400 A002K 240/50	27002379	240/50	3	1	163	90	149.8	143.5	3.36	75	30.6	0.43	45.0	2.10
HI/HS	400	4.45	OFBS 400 A005K 220/60	27002343	220/60	4	2	133	80	–	113.5	3.00	75	28.4	0.45	40.0	2.10

Ⓢ  $\lambda > 0.9$

Ⓜ mean value, measured at 25 °C copper temperature

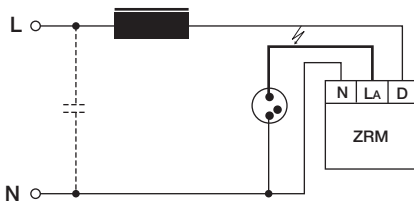

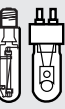

**Magnetic chokes**  
**High pressure sodium lamps and metal halide lamps**

**OFBIS/OFBS 250–400 W with thermal protection**



- $t_w = 130\text{ }^\circ\text{C}$
- resetting thermal protector switch off temperature  $150\text{ }^\circ\text{C}$

Packaging:	Code	Box	Pallet
OFBIS 250	1	4	288
OFBS 250 A02xW	2	4	228
OFBS 400	3	4	216
OFBS 400 A02xW	4	4	228

**Standards:**  
 EN 61347/923

Figure 1

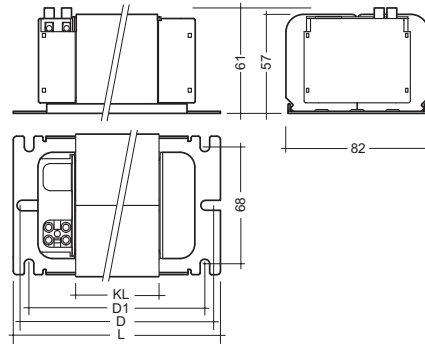

screw terminal 1–4 mm<sup>2</sup>

Figure 2

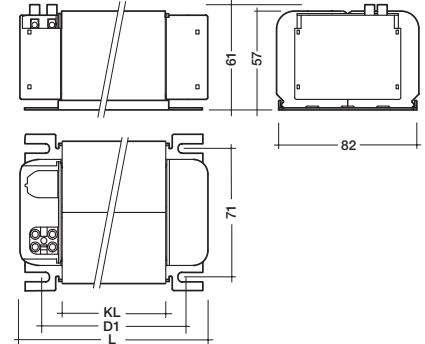

screw terminal 1–4 mm<sup>2</sup>

Lamp		Choke												P. F. Correction			
type	watt-age W	nominal lamp current A	type	article number	voltage V	pack-aging code	fig.	length L mm	KL mm	fixing centres mm		weight kg	$\Delta T$ K	losses W ②	$\lambda$	parallel capacitor $\mu\text{F} \pm 10\%$ 250V	line current A ①
										D	D1						
HI/HS	250	3.00	OFBIS 250 A000W	220/50	27002371	220	1	133	60	119.8	113.5	2.32	70	20.8	0.43	32.0	1.35
HI/HS	250	3.00	OFBIS 250 A001W	230/50	27002370	230	1	133	60	119.8	113.5	2.32	75	22.1	0.40	32.0	1.35
HI/HS	250	3.00	OFBIS 250 A002W	240/50	27002369	240	1	133	60	119.8	113.5	2.32	75	23.4	0.40	32.0	1.35
HI/HS	250	3.00	OFBIS 250 A021W	230/50	27002372	230	2	104	60	–	80–88	2.42	75	22.1	0.39	32.0	1.35
HI/HS	250	3.00	OFBIS 250 A022W	240/50	27002426	240	2	104	60	–	80–88	2.42	80	23.4	0.40	32.0	1.35
HI/HS	400	4.45	OFBS 400 A000W	220/50	27002382	220	3	163	90	149.8	143.5	3.45	70	29.0	0.45	45.0	2.10
HI/HS	400	4.45	OFBS 400 A001W	230/50	27002381	230	3	163	90	149.8	143.5	3.49	75	29.8	0.43	45.0	2.10
HI/HS	400	4.45	OFBS 400 A002W	240/50	27002380	240	3	163	90	149.8	143.5	3.49	75	30.6	0.43	45.0	2.10
HI/HS	400	4.45	OFBS 400 A021W	230/50	27002383	230	4	134	90	–	110–118	3.46	75	29.8	0.40	45.0	2.10
HI/HS	400	4.45	OFBS 400 A022W	240/50	27002425	240	4	134	90	–	110–118	3.46	80	30.6	0.43	45.0	2.10

①  $\lambda > 0.9$

② mean value, measured at  $25\text{ }^\circ\text{C}$  copper temperature

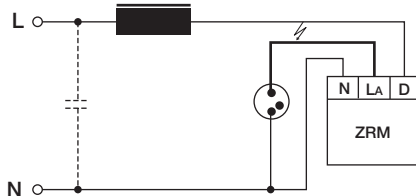

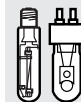

**Magnetic chokes**  
**High pressure mercury lamps**

**OFB 250-400 W**



•  $t_w = 130^\circ\text{C}$

Packaging:	Code	Box	Pallet
OFB 250	1	4	288
OFB 250 A02xK	2	4	228
OFB 400	3	4	288
OFB 400 A02xK	4	4	228
OFB 400 A02xW	5	4	228

**Standards:**  
EN 61347/923

**Figure 1**

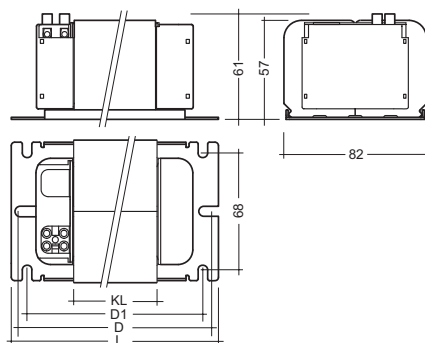

screw terminal 1 – 4 mm<sup>2</sup>

**Figure 2**

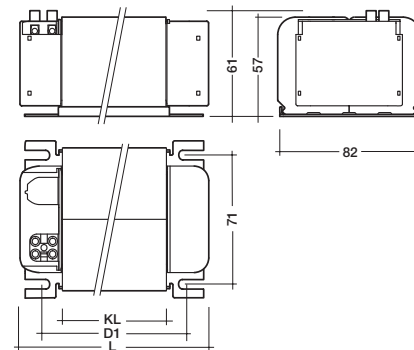

screw terminal 1 – 4 mm<sup>2</sup>

Lamp	Choke																P. F. Correction		
	type	watt- age W	nominal lamp current A	type	article number	voltage V	thermal protec- tion ③	pack- aging code	fig.	length L mm	KL mm	fixing centres mm		weight kg	$\Delta T$ K	losses W ②	$\lambda$	parallel	
												D	D1					capacitor $\mu\text{F} \pm 10\% 250\text{V}$	line current A ①
HM	250	2,15	OFB 250 A000K	220/50 040A113	27002373	220/50	no	1	1	113	40	99.8	93.5	1.8	70	17.3	0.54	18	1.25
HM	250	2,15	OFB 250 A001K	230/50 040A113	27002374	230/50	no	1	2	113	40	99.8	93.5	1.8	75	17.4	0.54	18	1.25
HM	250	2,15	OFB 250 A021K	230/50 040A076	27002409	230/50	no	2	1	84	40	–	60-68	1.76	75	17.4	0.54	18	1.25
HM	250	2,15	OFB 250 A002K	240/50 040A113	27002375	240/50	no	1	2	113	40	99.8	93.5	1.8	75	18.3	0.54	18	1.25
HM	250	2,15	OFB 250 A022K	240/50 040A076	27002410	240/50	no	2	1	84	40	–	60-68	1.76	75	18.3	0.54	18	1.25
HM	400	3,25	OFB 400 A000K	220/50 060A133	27002384	220/50	no	3	1	133	60	119.8	113.5	2.44	75	20.8	0.57	25	2
HI	400	3,50	OFB 400 A000K	220/50 060A133	27002384	220/50	no	3	1	133	60	119.8	113.5	2.44	75	20.8	0.52	25	2
HM	400	3,25	OFB 400 A001K	230/50 060A133	27002385	230/50	no	3	1	133	60	119.8	113.5	2.44	75	21.4	0.57	25	2
HI	400	3,50	OFB 400 A001K	230/50 060A133	27002385	230/50	no	3	1	133	60	119.8	113.5	2.44	75	21.4	0.52	25	2
HM	400	3,25	OFB 400 A021K	230/50 060A096	27002411	230/50	no	4	2	104	60	–	80-88	2.42	75	21.4	0.57	25	2
HI	400	3,50	OFB 400 A021K	230/50 060A096	27002411	230/50	no	4	2	104	60	–	80-88	2.42	75	21.4	0.52	25	2
HM	400	3,25	OFB 400 A021W	230/50 060A096	27002413	230/50	yes	5	2	104	60	–	80-88	2.42	75	21.4	0.57	25	2
HI	400	3,50	OFB 400 A021W	230/50 060A096	27002413	230/50	yes	5	2	104	60	–	80-88	2.42	75	22.6	0.52	25	2
HM	400	3,25	OFB 400 A002K	240/50 060A133	27002386	240/50	no	3	1	133	60	119.8	113.5	2.44	75	22.6	0.57	25	2
HI	400	3,50	OFB 400 A002K	240/50 060A133	27002386	240/50	no	3	1	133	60	119.8	113.5	2.44	75	22.6	0.52	25	2
HM	400	3,25	OFB 400 A022K	240/50 060A096	27002412	240/50	no	4	2	104	60	–	80-88	2.42	75	22.6	0.57	25	2
HI	400	3,50	OFB 400 A022K	240/50 060A096	27002412	240/50	no	4	2	104	60	–	80-88	2.42	75	22.6	0.52	25	2
HM	400	3,25	OFB 400 A022W	240/50 060A096	27002414	240/50	yes	5	2	104	60	–	80-88	2.42	75	22.6	0.57	25	2
HI	400	3,50	OFB 400 A022W	240/50 060A096	27002414	240/50	yes	5	2	104	60	–	80-88	2.42	75	22.6	0.52	25	2

①  $\lambda > 0.9$

② mean value, measured at 25 °C copper temperature

③ resetting thermal protector switch off temperature 150 °C

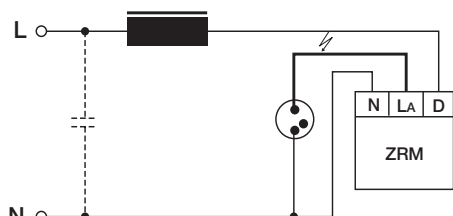

OFB with HI Lamp

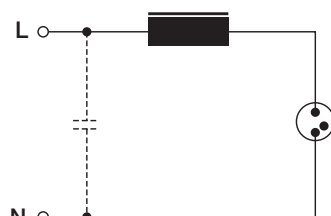

OFB with HM Lamp