



**Magnetic chokes**  
**Linear lamps, compact lamps**

**EC 5–40 W 230 V 50 Hz with thermal protection**



- $t_w = 130\text{ °C}$
- push terminal 0.5–1.5 mm<sup>2</sup>
- resetting thermal protector
- switch off temperature 110 °C

**Packaging core stack length 27 mm:**

box of 51  
36 boxes/pallet  
1836 pieces/pallet

**Packaging core stack length 90 mm:**

box of 25  
36 boxes/pallet  
900 pieces/pallet

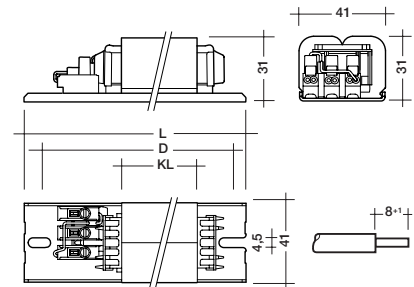

**Certified:**  
EN 60921  
EN 61347-1  
EN 61347-2/8

Lamp				Choke							P. F. Correction				③
watt-age	length	dia-meter	nominal lamp current	type	article number	length	core stack length	fixing centres	weight	$\Delta T$	$\lambda$	parallel capacitor	① line	series capacitor	
W	mm	mm	A			L mm	KL mm	D mm	kg	K		$\mu\text{F } \pm 10\% 250\text{V}$	current A	$\mu\text{F } \pm 4\%$	

**Compact lamps**

**Energy Efficiency Index EEI = B1**

18	TC-D	0.220	<b>EC 18 TCD B101W</b> 230/50	22149297	84.5	27	74–80	0.3	50	0.46	2.0	0.11	–	B
18	TC-L	0.375	<b>EC 18 B141W</b> 230/50	22149298	155	90	141–149	0.84	30	0.29	4.5	0.10	2.7 / 480V	B
24	TC-L	0.345	<b>EC 18 B141W</b> 230/50	22149298	155	90	141–149	0.84	25	0.39	3.0	0.13	2.5 / 450V	B
26	TC-D	0.325	<b>EC 18 B141W</b> 230/50	22149298	155	90	141–149	0.84	25	0.43	3.0	0.14	2.5 / 450V	B
28	TC-DD	0.320	<b>EC 18 B141W</b> 230/50	22149298	155	90	141–149	0.84	25	0.46	3.0	0.15	–	B
36	TC-L	0.435	<b>EC 36 B141W</b> 230/50	22149299	155	90	141–149	0.84	30	0.44	4.5	0.22	3.4 / 450V	B
38	TC-DD	0.430	<b>EC 36 B141W</b> 230/50	22149299	155	90	141–149	0.84	30	0.45	4.5	0.22	–	B

**Energy Efficiency Index EEI = C**

5	TC-S	0.180	<b>EC 9 A101W</b> 230/50	22149204	84.5	27	74–80	0.3	50	0.28	2.0	0.05	–	B
7	TC-S	0.175	<b>EC 9 A101W</b> 230/50	22149204	84.5	27	74–80	0.3	50	0.32	2.0	0.05	–	B
9	TC-S	0.170	<b>EC 9 A101W</b> 230/50	22149204	84.5	27	74–80	0.3	50	0.37	2.0	0.06	–	B
11	TC-S	0.155	<b>EC 9 A101W</b> 230/50	22149204	84.5	27	74–80	0.3	40	0.45	2.0	0.07	–	B

**Linear lamps**

**Energy Efficiency Index EEI = B1**

18	590	26	0.370	<b>EC 18 B141W</b> 230/50	22149298	155	90	141–149	0.84	30	0.3	4.5	0.13	2.7 / 480V	B
2x18	590	26	0.410②	<b>EC 36 B141W</b> 230/50	22149299	155	90	141–149	0.84	30	0.45	4.5	0.22	–	B
23	970	26	0.290	<b>EC 18 B141W</b> 230/50	22149298	155	90	141–149	0.84	20	0.4	3	0.14	2.4 / 450V	B
36	1200	26	0.430	<b>EC 36 B141W</b> 230/50	22149299	155	90	141–149	0.84	30	0.43	4.5	0.22	3.4 / 450V	B
38	1047	26	0.430	<b>EC 36 B141W</b> 230/50	22149299	155	90	141–149	0.84	30	0.45	4.5	0.22	3.4 / 450V	B
U40	607	38	0.430	<b>EC 36 B141W</b> 230/50	22149299	155	90	141–149	0.84	30	0.45	4.5	0.24	3.4 / 450V	B
φ40	409	30	0.415	<b>EC 36 B141W</b> 230/50	22149299	155	90	141–149	0.84	30	0.43	4.5	0.24	3.4 / 450V	B

①  $\cos \phi > 0.9$

② lamp current, measured in parallel connection

③ A ... standard article

B ... on request